

D4HT HEATED

DIMENSION SERIES

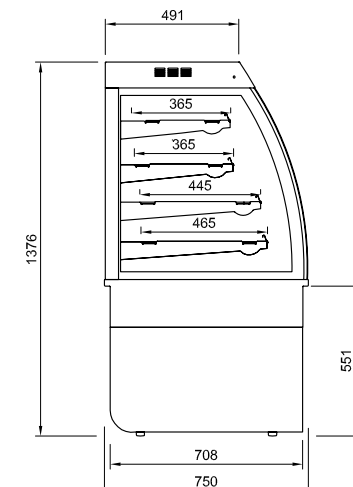

- Sliding doors front and rear
- Deck forced heating
- Single glazed glass
- Four adjustable shelves
- Ticket strips on shelves and base
- Undershelf and canopy lights
- Plinth, castors and skirt
- Available in two lengths

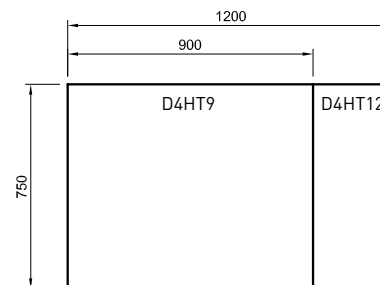

D4HT HEATED

SERVICES REQUIREMENTS DIMENSION SERIES

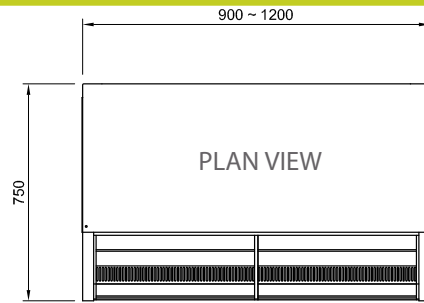

ELECTRICAL POWER

Electrical power cord 1500mm long

All units 3 pin 10 amp 1 phase
- plug can be removed and unit
hard wired on site

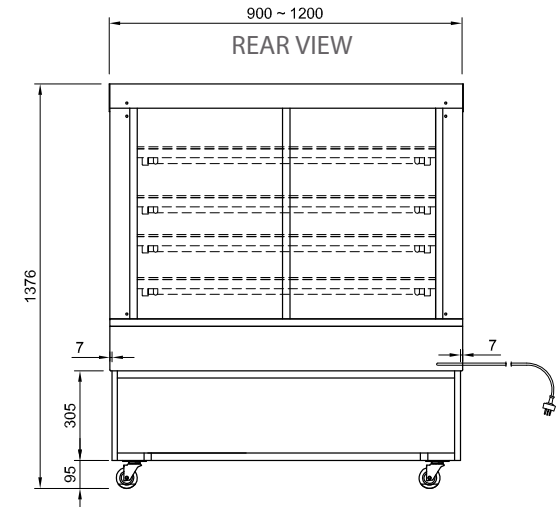
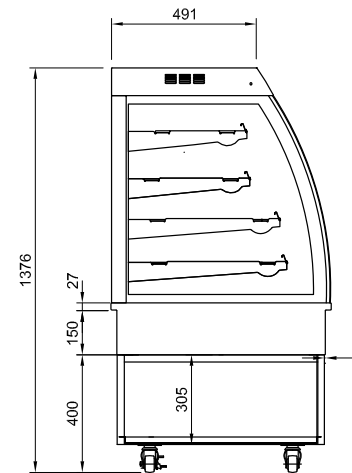
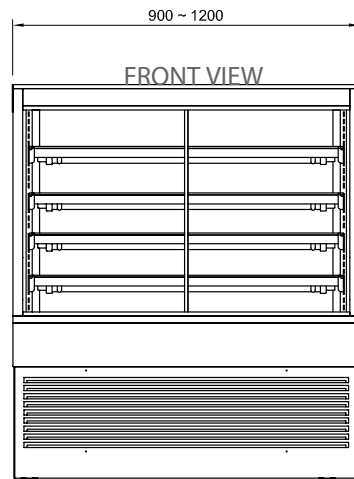
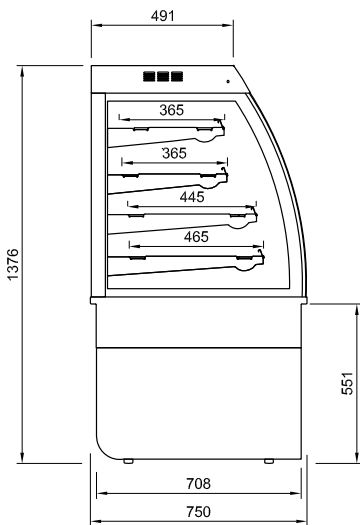

■ Stand Alone Heated Unit With Covers

■ DIMENSION D4 HT - Heated Unit Services

D4 INSTALLATION OPTIONS FOR NIB WALL

D4 SERIES

50mm gap



Free standing unit
Positioned behind
nib wall. Counters or
additional cabinets
are typically positioned
each side.

A 50mm gap is recommended
between hot and cold
adjoining units.

Always remove Stainless
Steel plinth covers before
butting up to nib wall.

Floating front panel option

Unit pushed into
low bench unit.



Vent to line up
with Condenser unit

Front ducted vent option

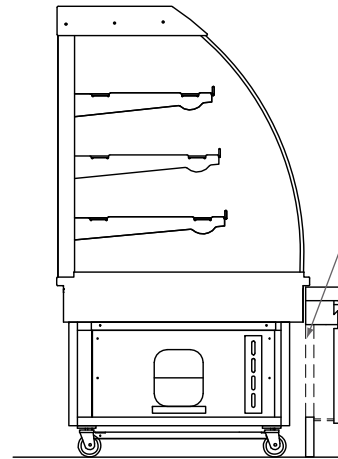

Remove front grill plinth cover
from front of unit to offer better
air flow into condenser face.

Removable front panel

Section - Unit with floating front panel

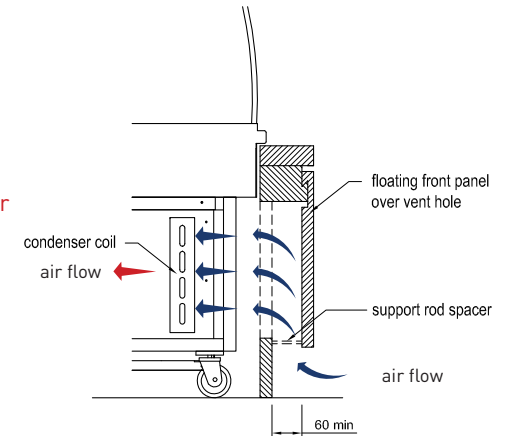

Enlarged Section - Unit with floating front panel

CLEANING ALLOWANCE ALL SITUATIONS

If unit is to be placed in a situation where
it cannot be easily moved consideration
must be give for regular cleaning of the
condensor vanes. ie removable front
vent or panel

Remove front grill plinth cover
from front of unit to offer better
air flow into condenser face.

Removable vented
grill to front.

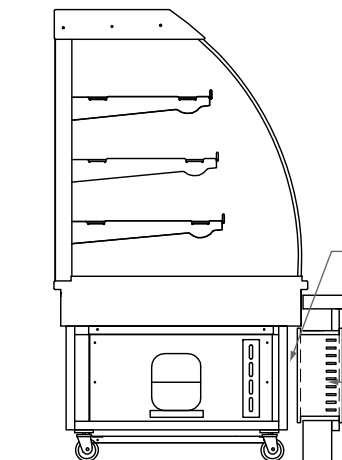

Section - Unit with vent

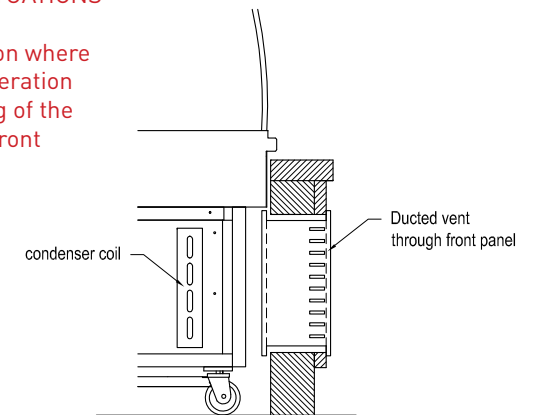

Enlarged Section - Unit with vent

COSSIGA AIR FLOW USAGE GIUDE

USAGE GUIDE LINES

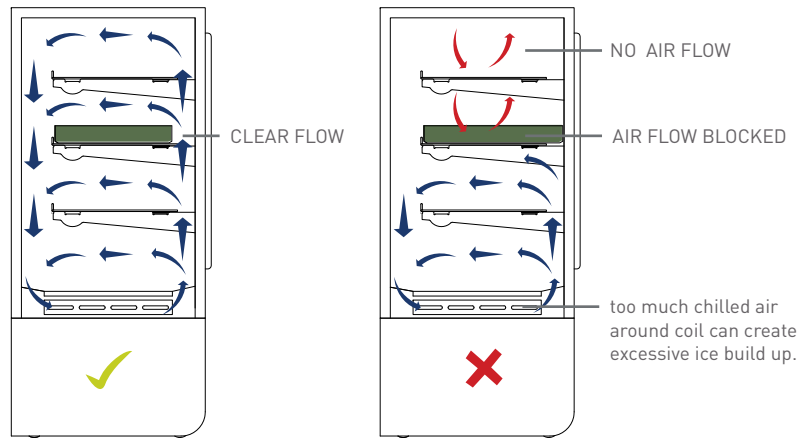

CORRECT AIRFLOW.

INCORRECT AIRFLOW.

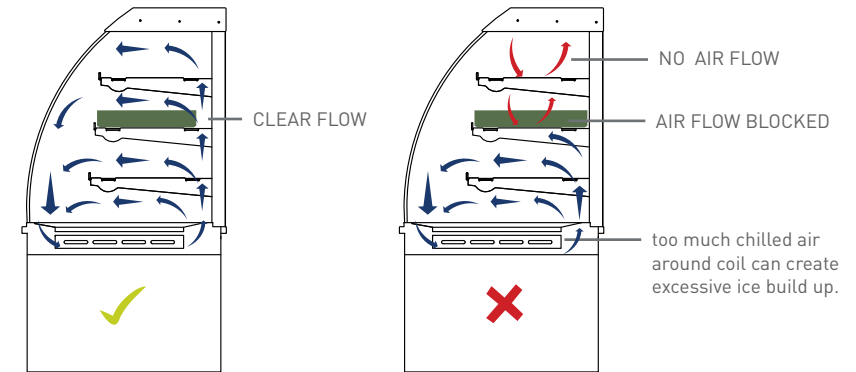

CORRECT AIRFLOW.

INCORRECT AIRFLOW.

Internal Air Flow Requirements

CORRECT AIRFLOW ✓
for both hot and cold units.

Vents are not blocked at base and ensure trays or plates are not blocking airflow at the rear of the unit.

INCORRECT AIRFLOW ✗
for both hot and cold units.

Blocked airflow disturbs correct air movement and creates uneven temperatures inside unit.

Ensure bottom vents are not blocked by plates or product.
Blocked air flow will retard operation on both HOT and COLD unit.

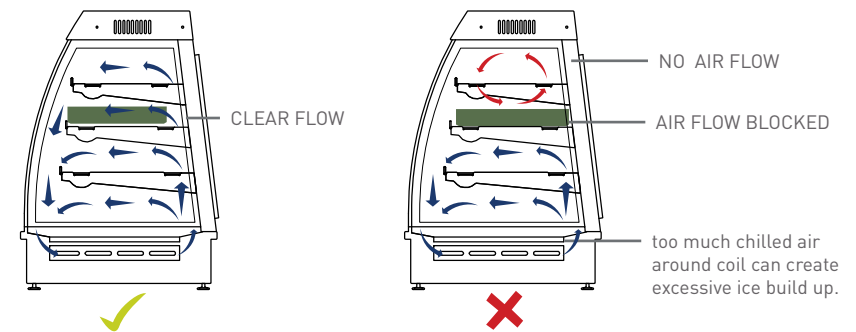

CORRECT AIRFLOW.

INCORRECT AIRFLOW.